

NATIONAL ORGANIZATION
SONS OF UNION VETERANS OF THE CIVIL WAR
 CIVIL WAR MEMORIAL ASSESSMENT FORM

PLEASE:

- Type or print, using a ball-point pen, when filling out this form. Legibility is critical.
 - Do not guess at the information. An answer of, "Unknown," is more helpful.
 - Include a photograph of each viewable side and label it with name & direction of view.
- Thank You.

Type of Memorial

☐ Monument *with* Sculpture ☐ Monument with *Cannon*
☐ Monument *without* Sculpture ☒ Historical Marker ☒ Plaque

Affiliation

☐ G.A.R. (Post Name & No. _____) ☐ M.O.L.L.U.S.
☐ W.R.C. (Corps Name & No. _____) ☐ Other Allied Order
☐ SUVCW (Camp Name & No. _____) (Please describe below)
☐ DUVCW (Tent Name & No. _____)
☐ Other: _____

Original Dedication Date _____ Please consult any/all newspaper archives for a local paper's article that would have information on the *first* dedication ceremony and/or other facts on the memorial. Please submit a copy of your findings with full identification of the paper & date of publication. Thank you.

Location

The Memorial is *currently* located at:

Street/Road address or site location 700 Block of New Hampshire

City/Village Lawrence Township Lawrence County Douglas

The front of the Memorial faces: ☒ North ☐ South ☐ East ☐ West

Government Body, Agency, or Individual Owner (of private cemetery that Memorial is located in)...

Name City of Lawrence Dept./Div. _____

Street Address 6 E 6th Street

City Lawrence State Kansas Zip Code 66044

Contact Person David Corliss Telephone (785) _____

If the Memorial has been moved, please list former location(s)...

Physical Details

Material of Monument or base under a Sculpture or Cannon = ☐ Stone ☐ Concrete ☐ Metal ☐ Undetermined
 If known, name specific material (color of granite, marble, etc.) Black Granite

Material of the Sculpture = ☐ Stone ☐ Concrete ☐ Metal ☐ Undetermined
 If known, name specific material (color of granite, marble, etc.) _____
 If the Sculpture is of metal, is it solid cast or "hollow?" _____

Material of Plaque or Historical Marker / Tablet = Brass on a Concrete slab and granite

Material of Cannon = ☐ Bronze ☐ Iron - Consult known Ordnance Listing to confirm
 Markings on muzzle = _____

Markings on Left Trunion _____ Right Trunion _____
 Is inert ammunition a part of the Memorial? ☐ If so, describe _____

Approximate Dimensions (indicate unit of measure) - taken from tallest / widest points
 Monument or Base: Height _____ Width _____ Depth _____ or Diameter _____
 Sculpture: Height _____ Width _____ Depth _____ or Diameter _____

For Memorials with multiple Sculptures, please record this information on a separate sheet of paper for each statue and attach to this form. Please describe the "pose" of each statue and any weapons/implements involved (in case your photos become separated from this form). Thank you!

Markings/Inscriptions (on stone-work / metal-work of monument, base, sculpture)
 Maker or Fabricator mark / name? If so, give name & location found _____

The "Dedication Text" is formed: ☒ cut into material ☐ raised up from material face

Record the text (indicate any separation if on different sides...) Please use additional sheet if necessary.

The granite marker has an inscription "Here near a score of unarmed recruits were killed in Quantrill's raid of Aug. 21, 1863"

The brass plaque has the names of the members of 14th Kansas who were killed in Quantrill's raid.

(See attached photos)

Environmental Setting

(The general vicinity and immediate locale surrounding a memorial can play a major role in its overall condition.)

Type of Location

<input type="checkbox"/> Cemetery	<input type="checkbox"/> Park	<input type="checkbox"/> Plaza/Courtyard
<input type="checkbox"/> "Town Square"	<input type="checkbox"/> Post Office	<input type="checkbox"/> School
<input checked="" type="checkbox"/> Municipal Building	<input type="checkbox"/> State Capitol	Other: _____
<input type="checkbox"/> Courthouse	<input type="checkbox"/> College Campus	_____
<input type="checkbox"/> Traffic Circle	<input type="checkbox"/> Library	_____

General Vicinity☐ Rural (low population, open land)☒ Town☐ Suburban (residential, near city)☐ Urban / Metropolitan**Immediate Locale** (check as many as may apply)☐ Industrial ☐ Commercial☒ Street/Roadside within 20 feet ☐ Tree Covered (overhanging branches)☐ Protected from the elements (canopy or enclosure, indoors)☐ Protected from the public (fence or other barrier)

Any other significant environmental factor Both markers are located in the grassed area between the curb and sidewalk. It is a slightly lower than the surrounding area where leaves collect and the grass grows over the markers.

Condition Information**Structural Condition** (check as many as may apply)

The following section applies to Monuments *with* Sculpture, and Monuments without Sculpture -

including the base for Monuments with *Cannon*. Instability in the sculpture and its base can be detected by a number of factors. Indicators may be obvious or subtle. Visually examine the sculpture and its base.

If hollow, is the internal support unstable/exposed?
(look for signs of exterior rust)

Sculpture**Base**

Any evidence of structural instability?

(look for cracked joints, missing mortar or caulking or plant growth)

Any broken or missing parts?

(look for elements (i.e., sword, musket, hands, arms, etc. - missing due to vandalism, fluctuating weather conditions, etc.)

Any cracks, splits, breaks or holes?

(also look for signs of uneven stress & weakness in the material)

Surface Appearance (check as many as may apply)

Black crusting

Sculpture**Base**

White crusting

Etched, pitted, or otherwise corroded (on metal)

Metallic staining (run-off from copper, iron, etc.)

Organic growth (moss, algae, lichen or vines)

Chalky or powdery stone

Granular eroding of stone

Spalling of stone (surface splitting off)

Droppings (bird, animal, insect remains)

Other (e.g., spray paint graffiti) - Please describe...

Does water collect in recessed areas of the Memorial? ☐ Yes ☐ No ☐ Unable to tell

Surface Coating

Does there appear to be a coating? ☐ Yes ☐ No ☐ Unable to determine
If known, identify type of coating.

☐ Gilded ☐ Painted ☐ Varnished ☐ Waxed ☐ Unable to determine
Is the coating in good condition? ☐ Yes ☐ No ☐ Unable to determine

Basic Surface Condition Assessment (check one)

In your opinion, what is the general appearance or condition of the Memorial?

☐ Well maintained ☐ Would benefit from treatment ☐ In urgent need of treatment ☐ Unable to determine

Overall Description

Briefly describe the Memorial (affiliation / overall condition & any concern not already touched on) .
Both markers are in good shape but need to be relocated to be better seen.

Supplemental Background Information

In addition to your on-site survey, any additional information you can provide on the described Memorial will be welcomed. Please label each account with its source (author, title, publisher, date, pages). Topics include any reference to the points listed on this questionnaire, plus any previous conservation treatments - or efforts to raise money for treatment. Thank you.

Inspector Identification

Date of On-site Survey 3/1/10

Your Name Robert L. Wandel

Address 2731 Bonanza St

City Lawrence, KS 66046

State Kansas

Zip Code 66046

Telephone (785) 843*2385

Please send this completed form to:

Kevin P. Tucker, PDC, Chair

58 Forest Street

Wakefield, MA 01880

(617) 678-6003

civilwarmemorials@verizon.net

Robert L. Wandel
Camp Commander
St. S.J. Churchill
Camp #4
Dept. of Kansas.

Thank you for your help, and attention to detail.

SONS OF UNION VETERANS OF THE CIVIL WAR
National Civil War Memorials Committee

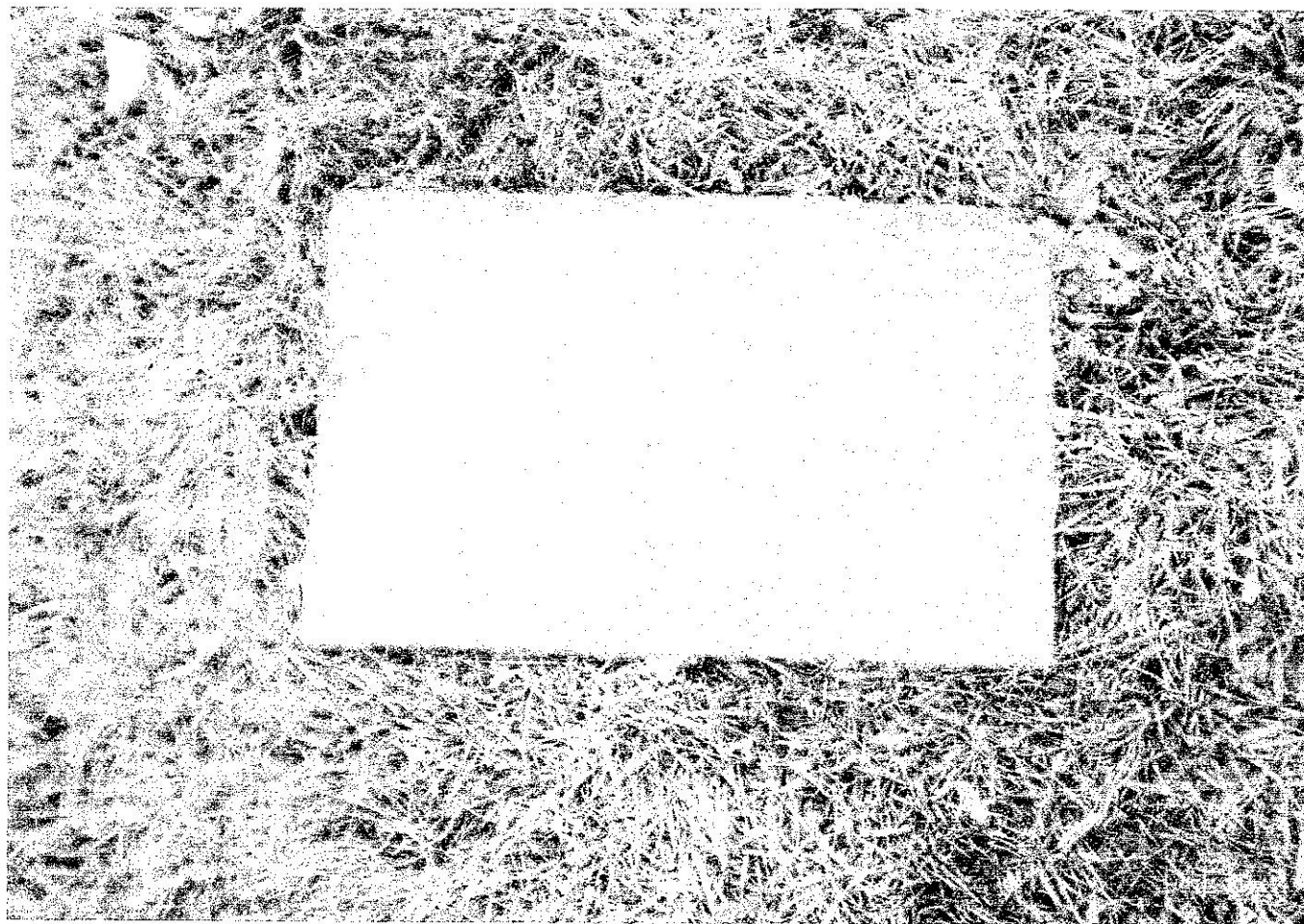

Marble Marker

3/1/10



Brass Plaque

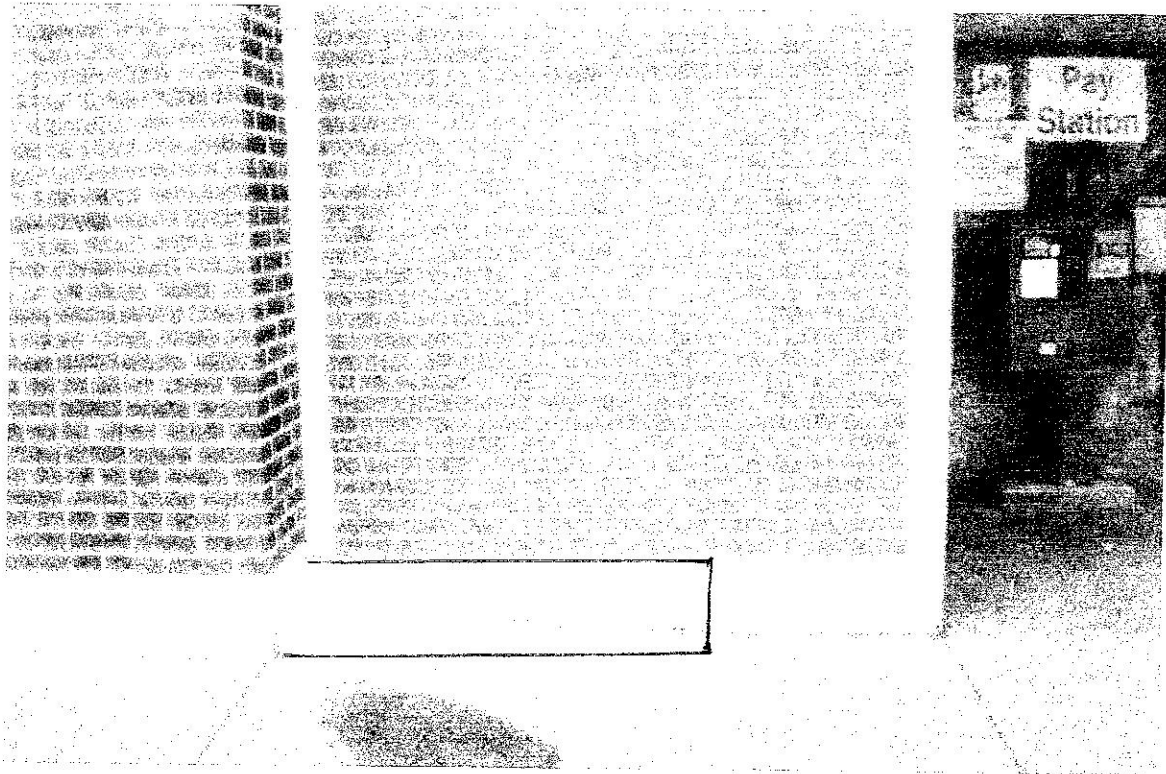

Proposed Location
of both markers.
(See sketch)

Proposed Relocation of Civil Markers

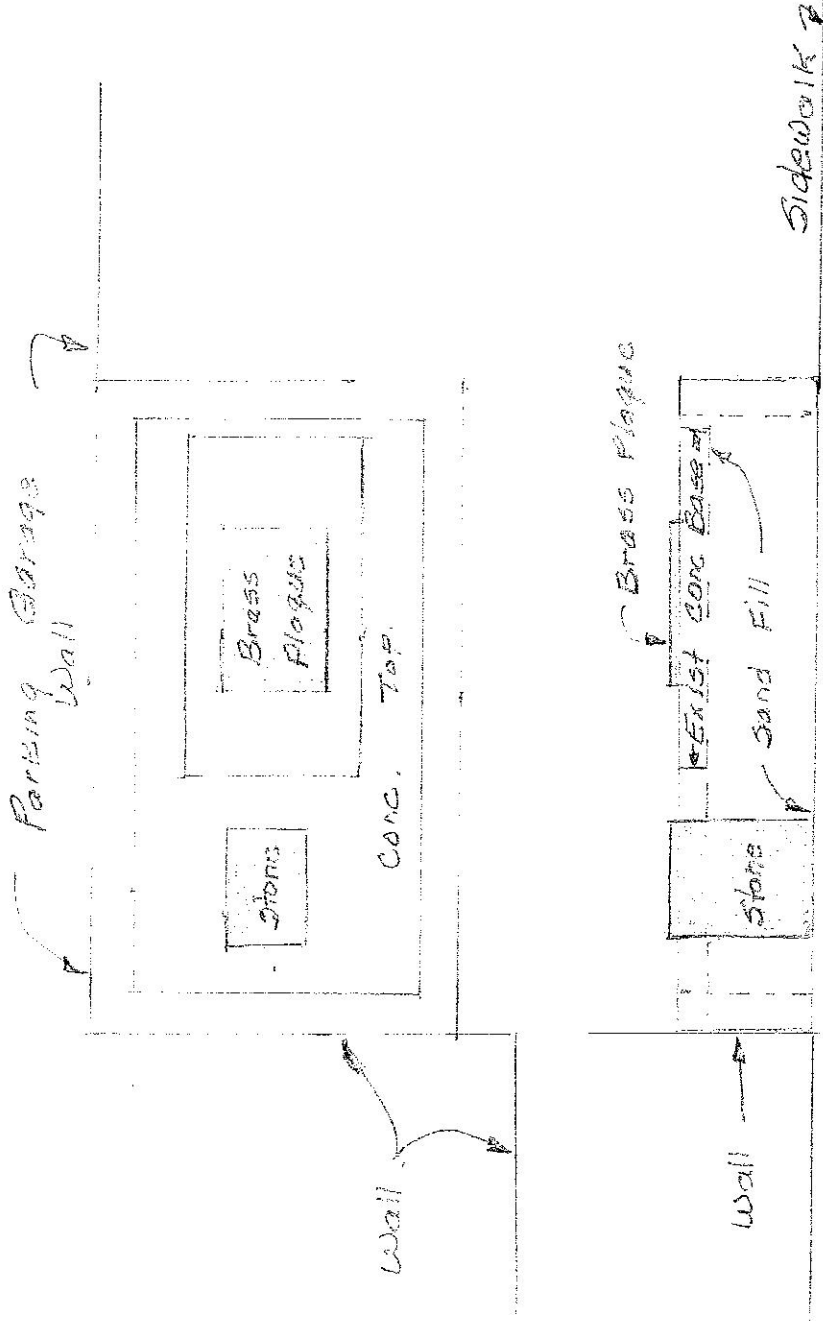

Approx. 3' Long x 2' Wide x 8" High
 City Parking Garage New Hampshire
 Street Lawrence, Kansas

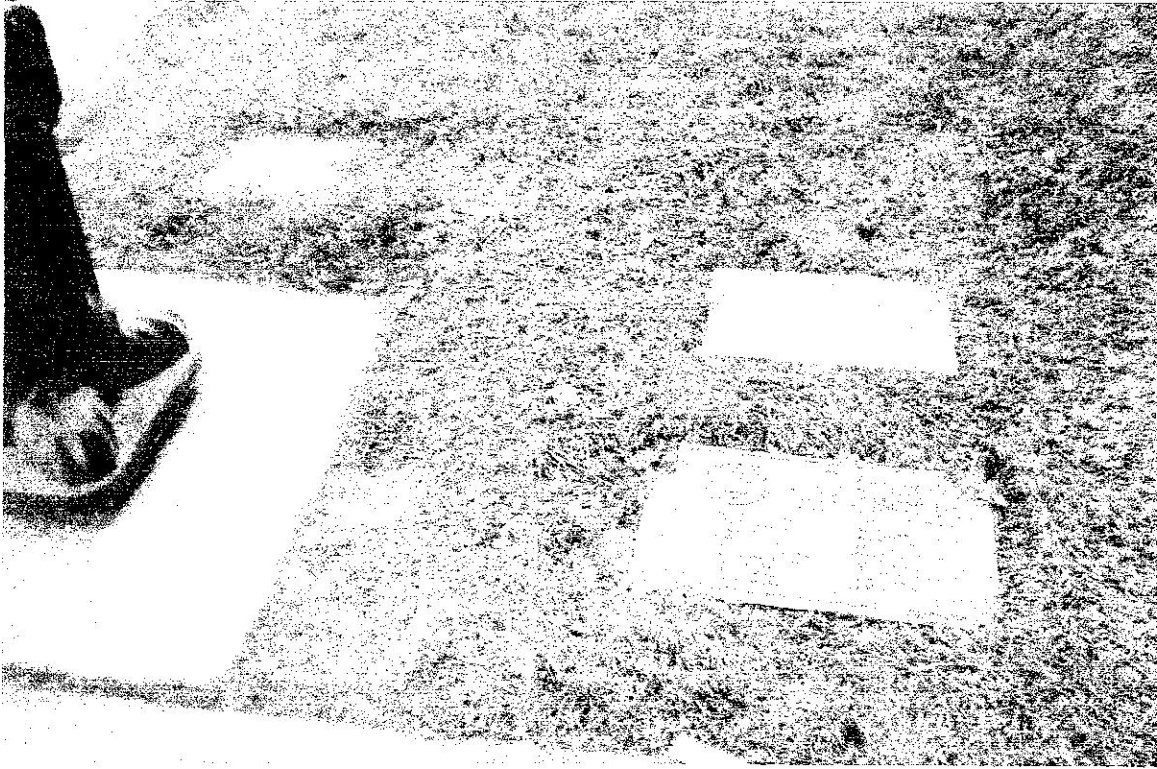

Both Markers in Current
Setting.

Entrance to Parking Garage



Showing current and
Proposed Location of
markers.